

## Coils & Electronic Controls

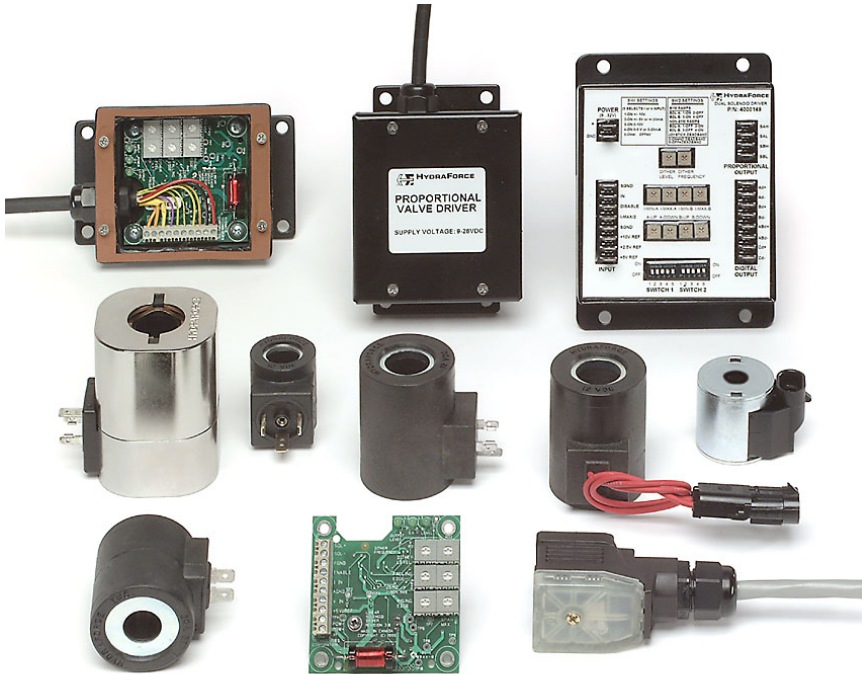

- Full Line of Electronic Proportional Valve Controllers including **New Rail-Mount Models**
- New Series E Water and Weather Resistant Coils Rated up to IP69K
- [Go to Hydraulic Proportional Valves](#)

### Coils for Solenoid-Operated Valves

[Standard Coils and Proportional Valve Coils](#)

[Standard Coil Weatherproofing \(For reference only. This style is obsolete as of Jan. 1, 2002\)](#)

[Series E Water / Weather Resistant Coils](#)

### Electronic Controls for Hydraulic Proportional Valves

[Intro. to Electro-Hydraulic Control Technology \(Tech. Ref. Info.\)](#)

[DIN Coil Mount Controllers](#)

[Remote-Mount, PCB \(Board Only\) Controllers](#)

[Remote-Mount, Metal Box Style Controllers](#)

[DIN Rail-Mount Style Controllers](#)

[Dual Solenoid Driver, Multi-Function](#)

[Controller Setup Instructions and Glossary of Terms \(Tech. Ref. Info.\)](#)

[Electronics in the Mobile Equipment Industries \(Tech. Ref. Info.\)](#)

## Electronic Controllers



### Electronic Controllers for Hydraulic Proportional Valves

#### DIN Coil Mount Controllers

Control Input Signal	Cat. Pg.
0–5 VDC, 10K Pot or 0–20 mA Input	<a href="#">3.510.1</a>
0–10 VDC Input	<a href="#">3.511.1</a>
4–20 mA Input	<a href="#">3.512.1</a>
10K Pot or 0–5 VDC Input (Economy)	<a href="#">3.513.1</a>
Soft Shift—12 or 24 VDC Input	<a href="#">3.514.1</a>

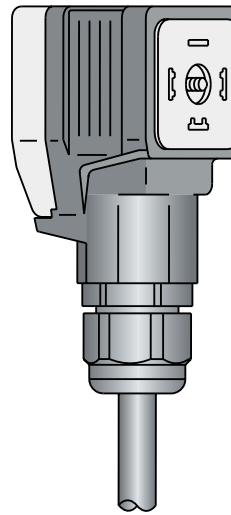

#### Remote-Mount PCB (Board-Only) Controllers

Control Input Signal	Cat. Pg.
0–5 VDC, 10K Pot or 0–20 mA Input	<a href="#">3.520.1</a>
0–10 VDC Input	<a href="#">3.521.1</a>
4–20 mA Input	<a href="#">3.522.1</a>
PWM (Pulse Train) Input	<a href="#">3.525.1</a>

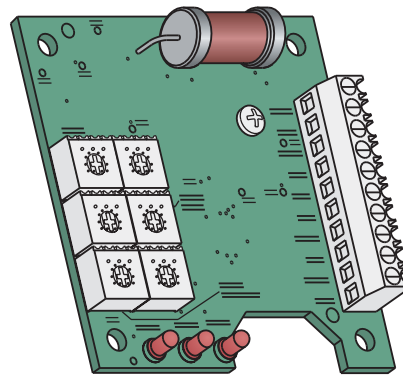

#### Remote-Mount Metal Box Controllers

Control Input Signal	Cat. Pg.
0–5 VDC, 10K Pot or 0–20 mA Input	<a href="#">3.530.1</a>
0–10 VDC Input	<a href="#">3.531.1</a>
4–20 mA Input	<a href="#">3.532.1</a>
PWM (Pulse Train) Input	<a href="#">3.535.1</a>

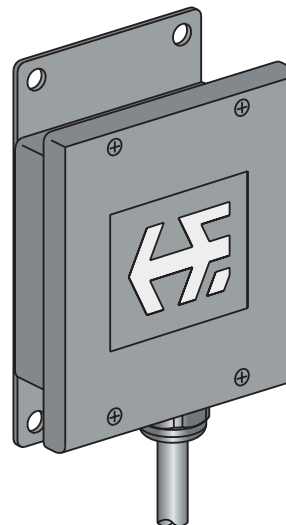

## Electronic Controllers



### Electronic Controllers for Hydraulic Proportional Valves

#### DIN Rail-Mount Style Controllers

Control Input Signal	Cat. Pg.
0–5 VDC, 10K Pot or 0–20 mA Input	<a href="#">3.540.1</a>
0–10 VDC Input	<a href="#">3.541.1</a>
4–20 mA Input	<a href="#">3.542.1</a>

New Models Highlighted

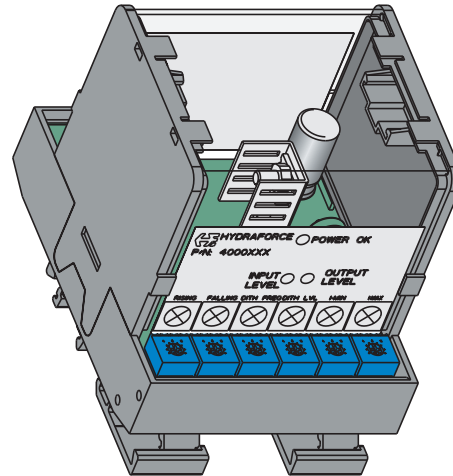

#### DIN Rail-Mount Style Controllers

Control Input Signal	Cat. Pg.
PWM (Pulse Train) Input	<a href="#">3.545.1</a>

New Model Highlighted

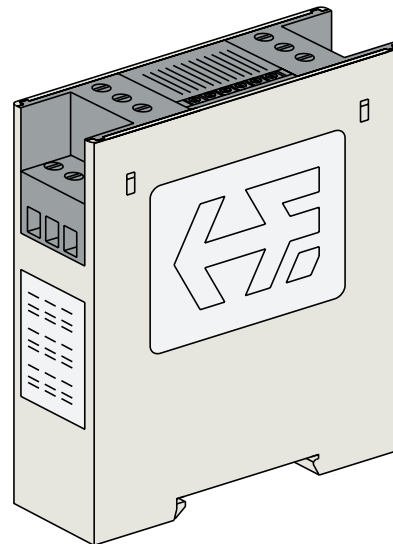

#### Dual Solenoid Driver, Multi-Function, Potted in Metal Box

Control Signal Input	Cat. Pg.
0–5 VDC, $\pm 5$ VDC, 0–10 VDC, 0–20 mA, $\pm 20$ mA	<a href="#">3.550.1</a>

